



DMG

Chemisch-Pharmazeutische Fabrik GmbH
Elbgastrasse 248 22547 Hamburg
www.dmg-hamburg.de

Honigum[®]-Heavy



CE

Honigum-Heavy is an innovative pre-impresion material based on A-silicones. Honigum-Heavy is available in two different application forms: ready-to-use pre-filled MixStar cartridges suitable for use in DMG MixStar and other commercially available mixing machines, and 50 ml Automix safety-cartridge for use in Automix-Dispenser Type 50 1:1.

Indication

Crown and bridge impressions, inlay and onlay impressions, all types of pickup impressions, e.g. for implants

Handling of the MixStar-Cartridge

Use in DMG MixStar

Please also refer to the respective instructions for use of the corresponding equipment.

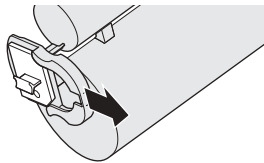

1. Slide locking mechanism into open position.
Do not remove the locking mechanism from the cartridge!

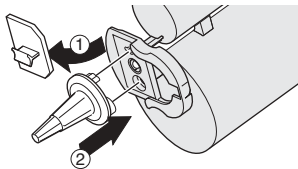

2. Remove and discard the cap on the openings of base and catalyst outlets and attach a new mixing tip.

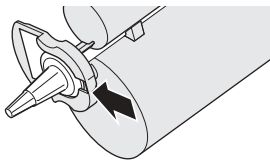

3. Secure the mixing tip by sliding the locking mechanism into locked position.

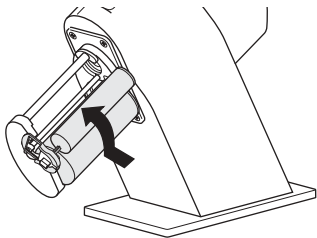

4. Insert the cartridge into the MixStar machine. A brief acoustical signal confirms the correct insertion of the cartridge.

Fresh cartridges are readied by discarding the first 3 cm of impression material that is extruded.

Leave used tips on the cartridge after use. They serve as a cap.

Use in Other Mixing Units

When using the MixStar-cartridge in mixing units of other manufacturers, insert the cartridge into the unit without the mixing tip first since, in this case, proper mixing is not warranted. Proceed in this case as described in "Exchanging the mixing tip" and refer to the instructions for use of the corresponding equipment.

Exchanging the Mixing Tip

Attach a new mixing tip before each use! For this, pull and remove old mixing tip and remove possible blockings from the cartridge opening. Attach a new mixing tip on the hex rod



first. Ensure that the drive rod properly engages the mixing tip by slightly rotating it. Align the mixing tip with respective outlets on the cartridge and attach it to the cartridge.

Handling of the Automix-Cartridge

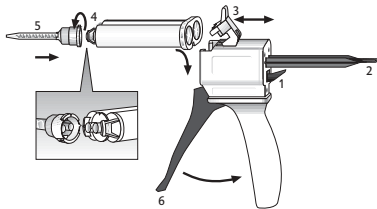

1. Push up the lever (1) at the back of the dispensing gun and pull back the slide (2) completely. Lift the plastic lever (3) on the top of the gun, insert cartridge and lock in by pushing down the lever (3). Ensure that the notch

on the cartridge is aligned with the notch on the dispensing gun.

2. Remove the cartridge cap (4) by turning 90° counter clockwise and discard. Push a new mixing tip (5) onto the cartridge. Note the corresponding notches. Turn the mixing tip 90° clockwise until it locks into position.
3. The material is mixed in the tip by pulling the trigger (6) of the dispenser and can be applied directly.

When using a cartridge for the first time, express a pea size amount of material and discard.

Leave the used tip on the cartridge until next use. It serves as a cap.

4. Push up the lever (1) at the back of the dispensing gun and pull the slide (2) back completely. Lift the plastic lever (3) and remove the cartridge.



Recommended Use

Impression Tray

Honigum-Heavy can be used in all common impression trays. To get better adhesion to metal or plastic trays, a tray adhesive may be applied.

Impression Taking

The prepared tray is loaded with the material. Hold tray slightly tilted under the mixing tip. To avoid air bubbles, the tip of the mixing tip should always stay immersed in the impression material. Introduce the tray into the mouth within working time and remove it after setting of the material.

For individual times please refer to the respective "Technical Data" below.

Do not mix Honigum-Heavy with condensation curing silicone or polyether type impression materials.

Special Techniques

Double Mixing Technique

Load the tray with Honigum-Heavy. While the tray is being loaded by the assistant, the dentist can begin to syringe the preparation with e.g. Honigum-Light. Loading of the tray and syringing should be completed at the same time as the higher temperature in the mouth leads to a quicker set of the wash impression material as compared to the tray material. Position the tray in the mouth and take the impression. After setting, the tray can be removed.

Correction Impression

Generous pressure relief channels for the wash impression material are cut and imperfections removed. After repositioning the pre-impression is carefully cleaned and dried. Apply a correction impression material such as Honigum-Light around the preparation and onto the



pre-impression. Insert the tray into the mouth and exert a short pressure. After setting, the tray can be removed.

To make sure that both materials bond properly, no more than 30 minutes should pass between the impression and the preliminary impression. The double mixing technique may be used alternatively.

Removal

Remove the impression parallel to the longitudinal axis of the prepared teeth. After removal, thoroughly clean with water and disinfect the impression.

Disinfection

Use only dipping solutions for the disinfection of the impression. Recommended is the use of a 2% glutaraldehyde solution. Please ensure that the used disinfectant is indicated for the use with addition curing silicone impression material. After removal from the mouth, clean

impression under running water for 15 seconds. Leave the impression in the disinfecting solution for about 10 to 15 minutes. Then rinse off the disinfection solution for 15 seconds under running water.

For more information, refer to the comments of the DGZMK. Comments of the DGZMK 3/93 V 1.0; www.dgzmk.de
ADA recommends following Council on Dental Materials, Instruments and Equipment. Disinfection of impressions. JADA 1991; 122(3): 110; www.ada.org

Casting and Galvanization

After disinfection, dry impression and store at normal room temperature (max. 78°F / 25°C). Impression should be poured 30 minutes at the earliest after removal from the mouth. We recommend using special purpose hard plaster (ISO 6873, Type 3; e.g. Moldano, Bayer) for the cast and an ultra hard dental plaster for the forms (ISO 6873, Type 4; e.g. Fujirock II, GC).



Honigum-Heavy impressions can be copper- or silverplated.

Storage of the Impression

Store impression at normal room temperature (78°F / 25°C). The impressions are stable and can be poured even after months without loss of accuracy.

Please Note

- Never allow the impression to come into contact with organic solvents or liquids containing same as this may result in swelling of the material and therefore may lead to inaccuracies.
- Possible residues of retraction aids can increase the setting time.
- Never allow the impression material to come into contact with latex gloves. Use of PVC or PE gloves is recommended.

Technical Data

Honigum-Automix Heavy

Working time*	2:00 Min
Recommended time in mouth	≥ 3:15 Min
Dimensional change after 24 h	≤ 0.4%
Compression set	≤ 0.5%
Strain in compression	≈ 1.4%

Honigum-Automix Heavy Fast

Working time*	1:15 Min
Recommended time in mouth	≥ 2:00 Min
Dimensional change after 24 h	≤ 0.4%
Compression set	≤ 0.5%
Strain in compression	≈ 1.4%

Honigum-MixStar Heavy

Working time*	2:15 Min
Recommended time in mouth	≥ 3:15 Min
Dimensional change after 24 h	≤ 0.4%
Compression set	≤ 0.5%
Strain in compression	≈ 1.4%



Honigum-MixStar Heavy Fast

Working time*	1:15 Min
Recommended time in mouth	≥ 2:00 Min
Dimensional change after 24 h	≤ 0.4%
Compression set	≤ 0.5%
Strain in compression	≈ 1.4%

* Times refer to normal room temperature (72 °F / 23 °C) and a normal relative humidity of air (50%). Higher temperatures shorten, lower temperatures increase those times.

Composition

Addition curing polysiloxanes, silicon dioxide, food pigments, additives, platinum catalyst

Classification

ISO 4823:2000, Type 1: Heavy-bodied consistency

Storage

Store and use in dry location at normal room temperature not exceeding 78°F / 25°C. We recommend not storing material in the refrigerator or in the freezer. Leave used mixing tip



on the cartridge after use. It serves as a cap. Do not use after expiration date.

Packaging

Not available in the USA

1 cartridge @ 390 ml paste, 10 MixStar-Tips	
Honigum-MixStar Heavy	REF 909537
Honigum-MixStar Heavy Fast	REF 909638

5 cartridges @ 390 ml paste, 50 MixStar-Tips	
Honigum-MixStar Heavy	REF 909538
Honigum-MixStar Heavy Fast	REF 909637

2 cartridges @ 50 ml paste, 4 Automix-Tips	
Honigum-Automix Heavy	REF 909766
Honigum-Automix Heavy Fast	REF 909838

8 cartridges @ 50 ml paste, 16 Automix-Tips	
Honigum-Automix Heavy	REF 909837
Honigum-Automix Heavy Fast	REF 909839

Only available in the USA

1 cartridge @ 390 ml paste, 10 MixStar-Tips
Honigum-MixStar Heavy REF 999537

4 cartridges @ 50 ml paste, 12 Automix-Tips
Honigum-Automix Heavy REF 999766

Caution: Federal Law restricts this device to sale by, or on the order of a dentist, or other practitioner licensed by law of the state in which he or she practices to use or order the use of this device.

Keep away from children. For dental use only.

